

Pocket Laser Tach PLT200

RoHS NIST



Pocket Laser Tach 200

Example Applications:

- Centrifuges
- Saw blades
- Grinders
- Elevators/escalators
- Engines
- Motors
- Conveyor belts
- Fans
- Propellers
- Vibration Studies

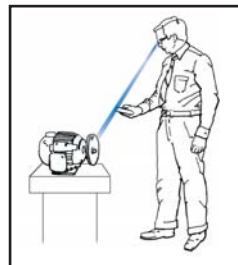

Safe and Accurate Non-Contact Measurements-View Target & Display Simultaneously

Two Tachs in One ... the only portable laser tachometer available with both Remote Contact and Remote Sensors.

Optional plug-in Remote Sensors with 8 foot cable. (25 foot cables available). See page 9 for details.



Remote Optical Sensor (ROS-P) Gap 36 inches



Remote Magnetic Sensor (MT-190-P) Gap 0.25 inches



Remote Infrared Sensor (IRS-P) Gap 0.50 inches

Remote Contact Assembly (RCA) with 6 foot (1.82m) cable, Contact Tips and 10 cm Linear Contact Wheel (Shows optional 12 inch circumference Linear Contact Wheel)



Optional RCA



Pulse Input/Output Cable Input/output cable with BNC connector



Protective Carry Pouch with belt loop (optional)



PLT200 shown with optical sensor and output cable



PLT200 and PT99 have a 1/4 20 threaded bushing for tripod mounting

The rugged and versatile Pocket Laser Tach is ideally suited for non-contact, contact and linear speed measurements.

Pocket Laser Tach 200 (PLT200) is a digital, battery-powered portable optical tachometer, which operates up to 25 feet (8 meters) from a reflective target using a class 2 laser light source. The ergonomic design allows safe, direct line-of-sight viewing of both the target and the display at the same time, while providing a non-slip rubber surface for single hand operation.

Multi-Function For Pro-Active Maintenance

PLT200 is a 32 function Tachometer/Ratemeter, Totalizer/Counter and Timer (stopwatch), which is programmable in both Imperial and Metric rates. Two phono plug connectors for our optional Remote Contact Assembly (RCA) or remote sensors. The PLT200 also has a TTL compatible pulse output to trigger devices like vibration data collectors or stroboscopes. The KIT is supplied complete with a Remote Contact Assembly including concave and convex tips and a 10 cm linear speed wheel all in a latching carrying case.

Pocket Laser Tach 200 Kit includes: Tachometer, RCA, Contact Tips, 10cm Linear Contact Wheel, 5 feet of Reflective Tape and a Latching Carrying Case.



PLT200 Kit

Specifications PLT200

- Display: 5 Digits, 5 Alphanumeric LCD
- Range(s): *Optical: 5 to 200,000 RPM
**Contact: 0.5 to 20,000 RPM

Rates	10cm Contact Wheel	12 inch circumference Contact Wheel
Inch/min	1.969 to 78,740 IPM	6,000 to 144,000 IPM
Feet/min	0.164 to 6,561.7 FT/M	0.500 to 12,000 FT/M
Yard/min	0.055 to 2,187.2 YPM	0.167 to 4,000.0 YPM
Cm/min	5.000 to 200,000 cm/M	15.240 to 365,760 cm/M
M/min	0.050 to 2,000.0 M/M	0.153 to 3,657.6 M/M

- Totalizer: 1-999,990 (events or length)
- Timer: 99:59.9 Min, sec, tenths
- Accuracy: Optical: $\pm 0.01\%$ of reading
Contact: $\pm 0.05\%$ of reading (rpm)
- Resolution: 0.001 to 10 RPM (range dependent)
- Operating Range: 2" to 25' (5cm to 7.62m), $\pm 70^\circ$ from perpendicular
- Memory: Maximum, Minimum and Last
- Power: (2) "AA" 1.5 VDC batteries (30 hours)
- Environmental: 5° to 40°C (40° to 105°F)
80% RH up to 31°C (88°F)
- Dimensions: 6.92 "H x 2.4" W x 1.6" D
(17.58 x 6.10 x 4.06cm)
- Weight: 7 oz. (210 g)

* performance subject to intensity of ambient light irradiation.
** also reads units per second and per hour.



Ordering Information

Pocket Laser Tach 200 Tachometer, N.I.S.T. traceable certificate of calibration, 12 inches of Reflective Tape.
 Pocket Laser Tach 200 Kit Tachometer with Latching Carrying Case, RCA, Tips and Linear Speed Wheel, Battery, 5 foot roll Reflective Tape, N.I.S.T. traceable certificate of calibration.
 ROS-P Remote Optical Sensor with Mounting Bracket and 8 foot cable for Pocket Laser Tach 200 only.
 ROS-P-25 Same as above with 25 foot cable.
 T-5 Reflective Tape, 5 foot roll, 1/2" wide.
 TTL pulse output cable
 Latching Carrying Case